

## E SERIES SWIVEL JOINTS

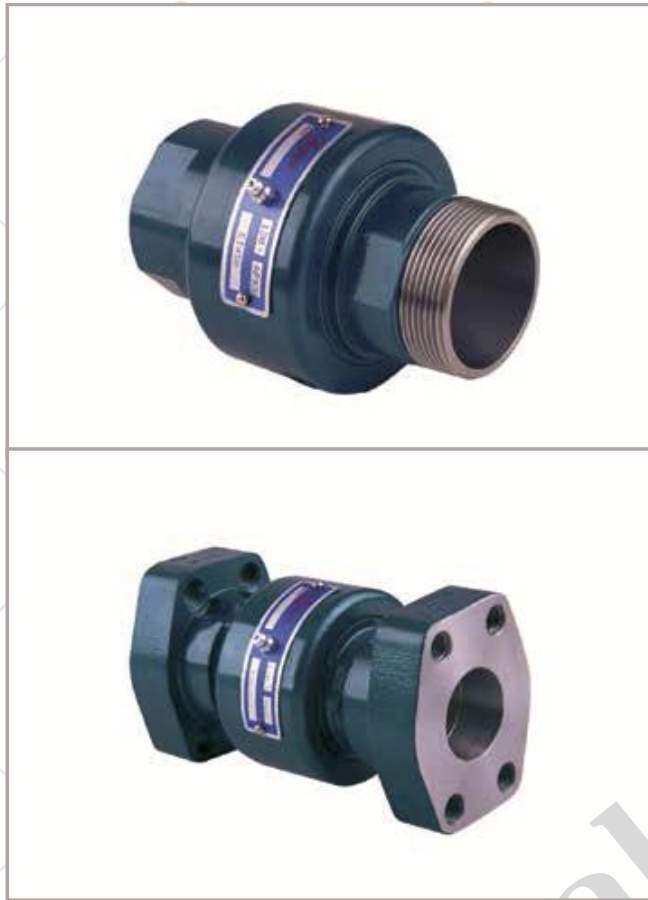

Water, Hydraulic Oil, Chemical Fluid,  
Liquid Food, Air

1/2" (DN15) - 3" (DN80)

- Single flow , axial
- Flanged, weld end connection
- Easy replacement of sealing parts
- For poor water quality
- Special sealing components (According to fluid)
- Carbon steel or stainless steel body
- Special inner sealing surface (hardened)
- All flange types are available (DN, ANSI etc..)

\*\*\* For further information please contact  
Rototech or local representative.

Working Conditions

Max. Water Pressure	: 250 bar
Max. Water Temperature	: 90°C
Max. Speed / RPM	: 1-20 Swivel Rotation

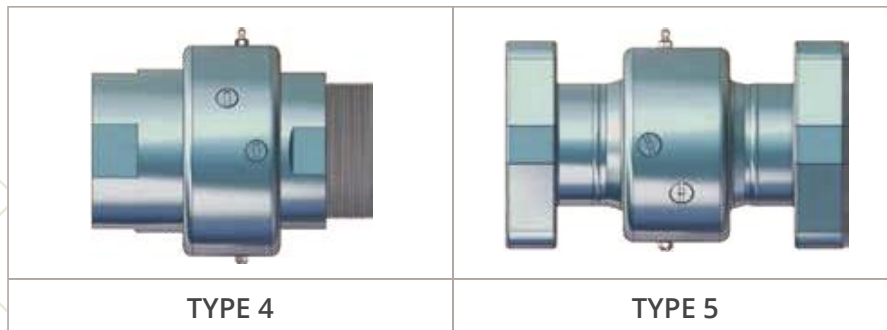

### E Series 1/2" (DN15) - 3" (DN80) Swivel Joints Type 1 (Weld end)

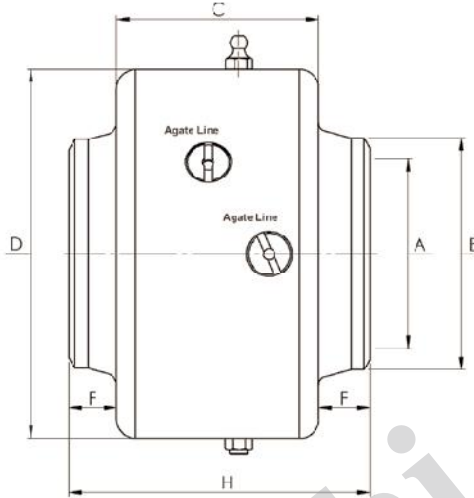
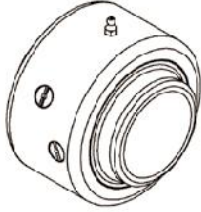

\*Custom sized manufacturing are available.



#### E SERIES SWIVEL JOINT - WELD END - TYPE 1

A	Code	B	F	D	C	H
1/2"	DN15 ET115	22	12,50	56	40	65
3/4"	DN20 ET120	27	12,50	61	42	67
1"	DN25 ET125	34	12,50	67	46	71
1 1/4"	DN32 ET132	42	12,50	79	48	73
1 1/2"	DN40 ET140	48	12,50	86	52	77
2"	DN50 ET150	61	12,50	97	53	78
2 1/2"	DN65 ET165	76	12,50	116	53	78
3"	DN80 ET180	96	12,50	124	60	85

### E Series 1/2" (DN15) - 3" (DN80) Rotary Joints Type 2 (Male to male thread)

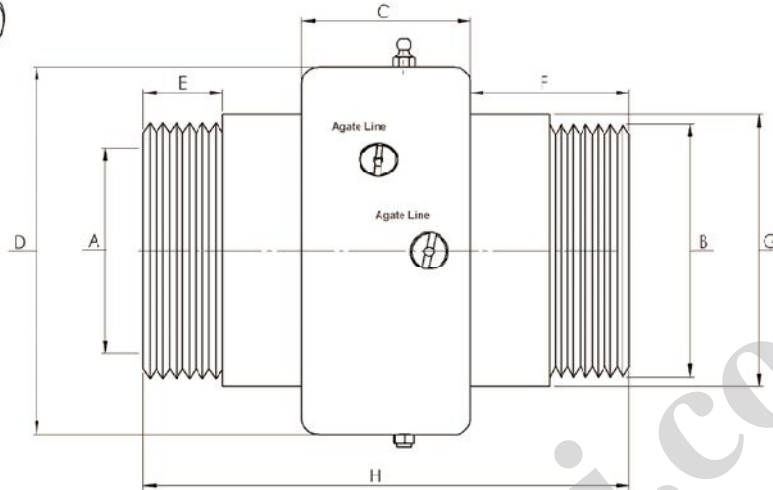

\*Custom sized manufacturing are available.

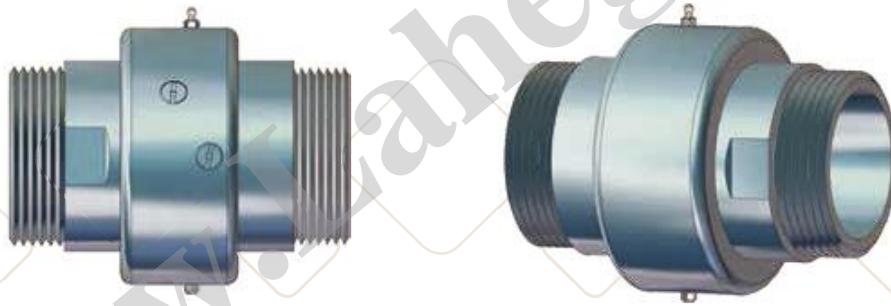

#### E SERIES SWIVEL JOINT - MALE TO MALE THREAD TYPE 2

A	Size	Code	B	C	D	E	F	G	H
1/2"	DN15	ET215	1/2"	45	56	14	34	32	113
3/4"	DN20	ET220	3/4"	45	61	14	34	32	113
1"	DN25	ET225	1"	46	67	20	40	40	126
1 1/4"	DN32	ET232	1 1/4"	58	79	20	40	48	138
1 1/2"	DN40	ET240	1 1/2"	60	86	20	40	48	140
2"	DN50	ET250	2"	53	97	25	50	60	153
2 1/2"	DN65	ET265	2 1/2"	53	116	25	50	86	153
3"	DN80	ET280	3"	60	124	30	60	100	158

### E Series 1/2" (DN15) - 3" (DN80) Swivel Joints Type 3 (Female to female)

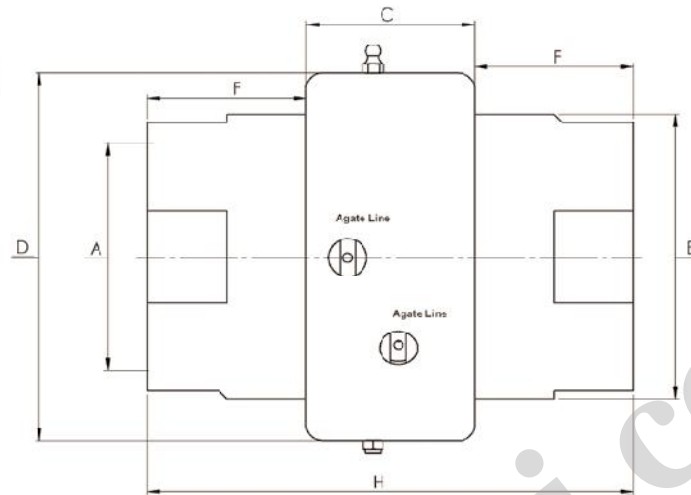

\*Custom sized manufacturing are available.

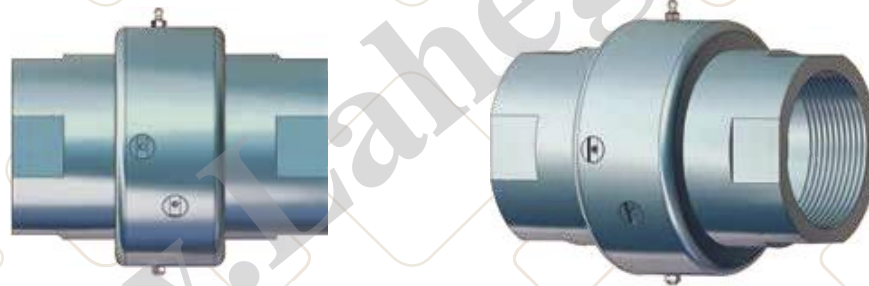

#### E SERIES SWIVEL JOINT - FEMALE TO FEMALE THREAD - TYPE 3

A	Code	B	F	D	C	F	H
1/2"	DN15	ET315	1/2"	20	56	45	82
3/4"	DN20	ET320	3/4"	20	61	45	82
1"	DN25	ET325	1"	20	67	40	86
1 1/4"	DN32	ET332	1 1/4"	20	79	40	98
1 1/2"	DN40	ET340	1 1/2"	20	86	40	92
2"	DN50	ET350	2"	25	97	50	103
2 1/2"	DN65	ET365	2 1/2"	42	116	50	137
3"	DN80	ET380	3"	40	124	60	140

### E Series 1/2" (DN15) - 3" (DN80) Swivel Joints Type 4 (Male to female thread)

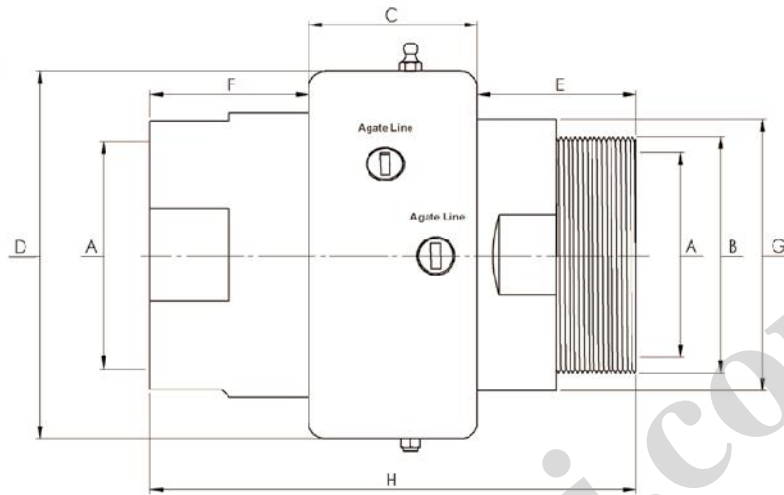

\*Custom sized manufacturing are available.

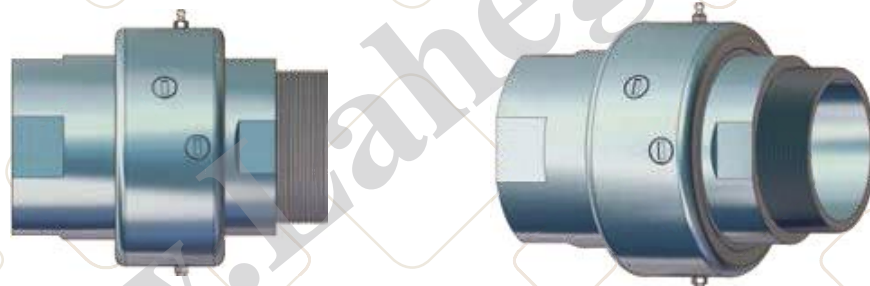

#### E SERIES SWIVEL JOINT - FEMALE TO MALE THREAD - TYPE 4

A	Code	B	C	D	F	E	G	H	
1/2"	DN15	ET415	1/2"	45	56	34	14	32	113
3/4"	DN20	ET420	3/4"	45	61	34	14	32	113
1"	DN25	ET425	1"	46	67	40	20	40	126
1 1/4"	DN32	ET432	1 1/4"	58	79	40	20	48	138
1 1/2"	DN40	ET440	1 1/2"	60	86	40	20	48	140
2"	DN50	ET450	2"	53	97	50	25	60	153
2 1/2"	DN65	ET465	2 1/2"	53	116	50	25	86	153
3"	DN80	ET480	3"	60	124	60	30	100	158

### E Series 1/2" (DN15) - 2" (DN50) Swivel Joints Type 5 (SAE3000 Flanged)

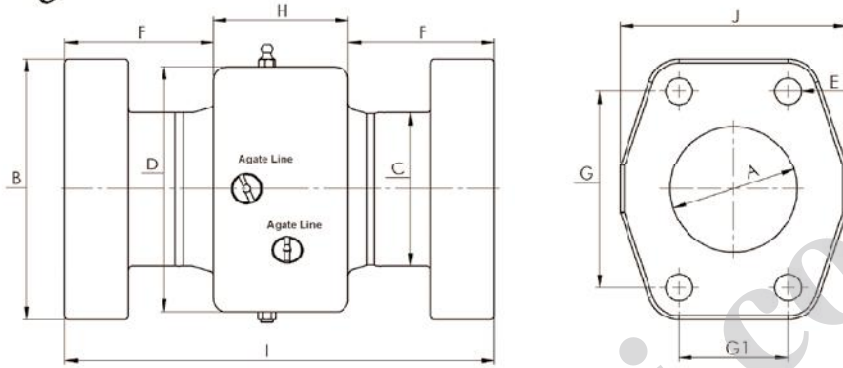
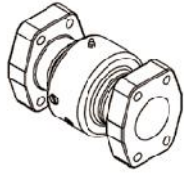

\*Custom sized manufacturing are available.

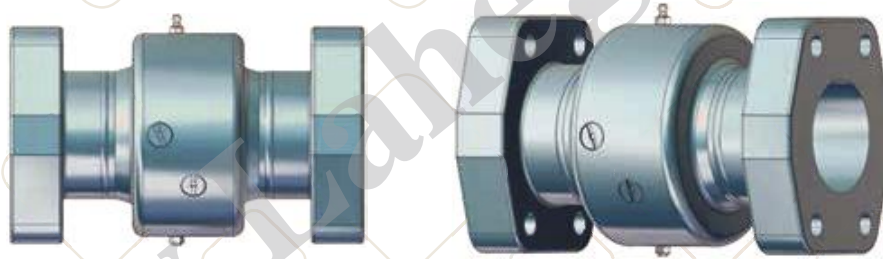

**E SERIES SWIVEL JOINT - SAE 3000 FLANGED - TYPE 5**

A	Code	B	C	D	E	F	G	G1	H	I	I	
1/2"	DN15	ET515	54	22	60	4 X Ø8	41	38,10	17,50	49	132	46
3/4"	DN20	ET520	66	27	68	4 X Ø10	53	47,60	22,20	49	155	52
1"	DN25	ET525	70	34	70	4 X Ø10	59	52,40	26,20	55	173	59
1 1/4"	DN32	ET532	79	42	79	4 X Ø10	65	58,70	30,20	55	185	73
1 1/2"	DN40	ET540	94	49	92	4 X Ø13,5	69	69,90	35,70	64	192	83
2"	DN50	ET550	102	61	109	4 X Ø13,5	55	77,80	42,90	68	192	97

