

## 1000 A SERIES ROTARY JOINTS



CONTINUOUS CASTING  
 WATER  
 1/2" (DN08) - 1 1/2" (DN40)

- Mono or duoflow
- In-the-shaft mounted
- Flat type housing
- Brass housing and elbow
- Stainless steel shaft and screws
- Self supported sealing parts
- Silicon Carbide sealing parts

### Working Conditions

Max. Water Pressure	:	10,5 Bar
Max. Water Temperature	:	120°
Max. Speed	:	100 rpm/min

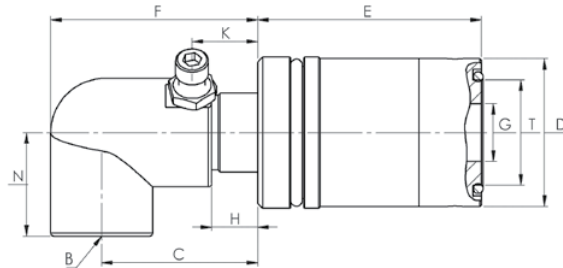
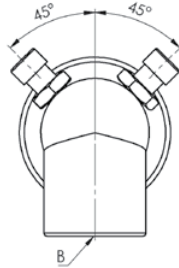
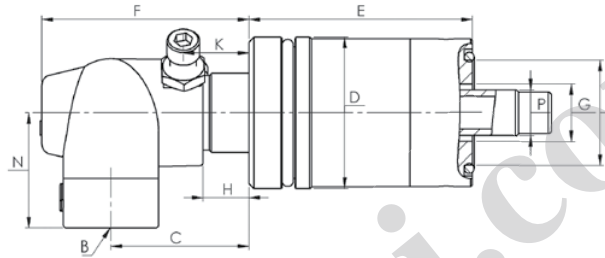
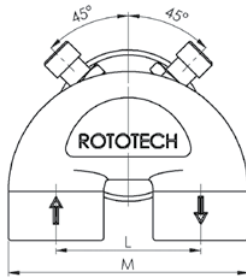

**1000 A Series 1/2" (DN15) - 1 1/2" (DN40) Single Flow Rotary Joints**

**1000 A Series 1/2" (DN15) - 1 1/2" (DN40) Duo Flow Rotary Joints**

**1000A SERIES ROTARY JOINTS**

Size	Type	B	Elbow Thread	Model No	F	E	D	T	K	H	G	N	L	M	C	P	Kg	
DN15	MONO FLOW	1/2"	BSP	1052-1200-000	63,00	54,00	40,00	25,00	20,00	14,00	13,50	31,50			47,00		2,00	
			NPT	1051-1200-000														
DN20		3/4"	BSP	1072-1300-000	63,00	69,00	46,22	32,00	20,00	14,00	17,50	31,50			47,00		2,20	
			NPT	1071-1300-000														
DN25		1"	1"	BSP	1102-1400-000	72,00	99,00	58,70	44,50	21,50	14,00	25,00	43,00			51,00		2,80
				NPT	1101-1400-000													
DN40	1 1/2"	1 1/2"	BSP	1152-1500-000	91,00	87,00	70,70	50,00	21,50	14,00	40,00	49,00			62,00		3,30	
			NPT	1151-1500-000														
DN15	DUAL FLOW	1/2"	BSP	1054-1300-000	63,00	54,00	40,00	25,00	20,00	14,00	13,50	35,00	44,00	73,00	42,00	13,00	2,40	
			NPT	1053-1300-000														
DN20		3/4"	BSP	1074-1400-000	72,00	99,00	58,70	44,50	20,00	14,00	25,00	39,00	51,00	85,00	47,00	19,00	3,00	
			NPT	1073-1400-000														
DN25		1"	1"	BSP	1104-1400-000	94,00	99,00	58,70	44,50	21,50	14,00	25,00	43,00	63,50	105,50	63,00	19,00	3,50
				NPT	1103-1400-000													
DN40	1 1/2"	1 1/2"	BSP	1152-1500-000	94,00	87,00	70,70	50,00	21,50	14,00	40,00	49,00	63,50	105,50	63,00	21,00	3,75	
			NPT	1151-1500-000														

